

DYCK ARBORETUM OF THE PLAINS PRAIRIE WINDOW

cultivating transformative relationships between people and the land

Summer 2022 Vol. 32 No. 2

Arboretum Island Renovated and Reopened

Last summer, a gift from the Hesston Community Foundation helped Arboretum staff renovate the man-made island that is the most popular destination on the grounds. Over the course of the winter, additional donations were given by individual donors as well as the Hesston Lions Club to meet our fundraising goal.

Here is an overview of the project phases that were completed between Fall of 2021 and Spring of 2022:

SHORING UP THE BANKS

Where needed, the original outer walls of the island, made of redwood 2x12s, were repaired and solidified.

Rubble and rock was dumped inside them in eroded areas along the bank to form a solid base. Eight to 12 inches of soil was smoothed and packed on top of the rocks. Our hope is that the existing vegetation will resprout. Along with the newly seeded species, their roots will hold the soil and reach down into the rocks as the soil filters through in the coming years.

SEEDING THE SOIL

Into this new soil, staff planted a seed mix in January. Establishing a wide diversity of host plants and nectar sources was the main goal of this planting. Using Prairie Moon Nursery

seed selections, we chose an array of prairie wildflowers with historical range in the mixed/tallgrass prairie of Kansas. The wildflowers amounted to 43 species, representing a variety of heights, colors, and bloom times and should add a nice array of plants and eventually attract more native wildlife to this area.

FORMING THE WILDLIFE OBSERVATION AREA

Limestone rocks on the south end of the island were placed on top of a level, crushed concrete pad from recycled sidewalk, which will hold the stones up out of the water, preventing deterioration. Additional rocks were placed a step up from the larger stones to retain the path gravel. These stones are a great place to sit and watch the wildlife. After all the soil was moved, paths renovated and stones in place, the land bridge was removed and the channel between the bank and the island was dredged out. It will take a few years for the soil to completely settle and for plants to get reestablished, but we look forward to watching the island garden redevelop in the next few years.

We are very grateful to everyone who contributed to this project!



Photo by Brenda Heard

Three new natives for FloraKansas

by Katie Schmidt, Grounds Manager and Horticulturist

We are excited to have found sources for several new important native species, and to be able to offer them to you this fall. Our fall FloraKansas Native Plant Days will kick off with our MEMBER DAY on Thursday, September 8 (8 am to 7 pm) and continue through the weekend, Friday, September 9 from 8 am to 7 pm, Saturday, September 10, 8 am to 5 pm and Sunday, September 11, 1 to 5 pm. We invite you to join us for this opportunity to support the Arboretum while you acquire plants that will attract diverse habitat to your garden!

SOLIDAGO SPECIOSA

As with every goldenrod, this is a pollinator magnet and important stop for insects as they gather late season energy. Much less aggressive than other goldenrods, showy goldenrod will not spread as readily via rhizome. In overly fertile or moist soil, it may seed out, but deadheading is always an option. Keep it in a well drained area in full sun, and enjoy the bright yellow blooms!



LIATRIS CYLINDRACEA

Eastern dwarf Liatris, possibly native to Kansas at one time is now found mostly in MO, WI, and IL. A great addition to a native garden that needs Liatris, but cannot accommodate the species in our range. For instance, Kansas gayfeather (*L. pycnostachya*) can be too tall and gangly in small plots, but *L. cylindracea* grows only 24 inches. *Liatris punctata* likes it quite dry, and may rot in garden soil that gets overspray from sprinkler systems. This Liatris would welcome a bit of extra moisture.



HYDROPHYLLUM VIRGINIANUM

Virginia waterleaf is native to the eastern third of Kansas, preferring shady sites with moist to average soil. You might find it growing near creeks or in open woods. It is great at filling spaces quickly, so use as a groundcover in your stubborn shade areas. Leaves are edible and make a nice addition to salad! It has a white to light purple bloom in spring and a very ornamental leaf pattern. Plant with sedges and woodland phlox for a naturalistic shade meadow.



PRE-ORDERING PLANTS

Whether you just can't make it to FloraKansas in-person or you've got an especially big order this year, let our staff help! **ALL MEMBERS MAY PRE-ORDER PLANTS AUGUST 15th THROUGH SEPTEMBER 2nd.** To ensure the greenhouse is well-stocked for FloraKansas, please submit your pre-orders as EARLY as possible.

Visit dyckarboretum.org/florakansas-fall to find a link to the order form, or call our office at 620-327-8127. Once your order is submitted, you will receive an email with information on pickup procedures. We process orders based on the date they are received, so get your order in early! You may pick up your plants as soon as you receive an invoice via email.

If you are not yet a member, but would like to pre-order, you may include a membership fee with your order. Welcome aboard!

Prairie Window Concert Series

Dyck Arboretum of the Plains, Hesston, KS • 2022-23

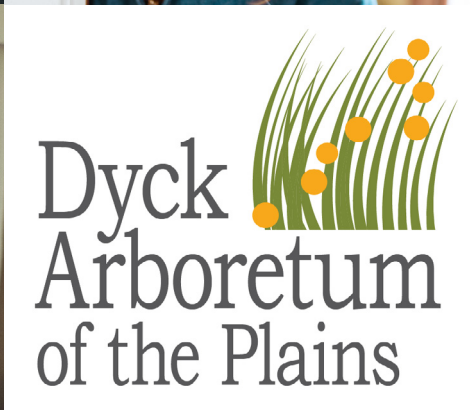

SEASON TICKET SPECIAL - THROUGH SEPTEMBER 30

ONE FREE SHOW and seating preference

Tickets and more information at dyckarboretum.org or 620-327-8127

**HESSTON
COLLEGE**
START HERE, GO EVERYWHERE



k m u w
WICHITA **89.1**

Member Garden Spotlight: Ron Flaming

by Janelle Flory Schrock, Public Engagement Coordinator

The act of curating an inviting outdoor space for oneself, one's family and for wildlife is something I'd like to draw attention to over a series of spotlight stories to share with our followers. If you are a member of the Arboretum who would like to share the story of your garden and your journey with Kansas native plants, please send me a message at arboretum@hesston.edu with the subject line, "Garden Spotlight".

At FloraKansas it's always a pleasure to hear from members who are renovating an entire landscape in native and adaptable plants all at once. Dramatic transformations have a wow factor about them, with the instant gratification of an "extreme makeover".

However, so many Dyck Arboretum members have been tending and transforming their gardens over several years or even several decades. This is the case with Ron Flaming's garden.

As a Harvey County Master Gardener, Ron's front garden is a well-tended quarter acre of lawn with

a few carefully selected species. A small planting of wildflowers surround a weeping understory tree at the curb.

But it's the back garden that really takes you on a native plant journey. Several river birch trees surround a puddling water feature and a rock garden by the patio. A few hummingbird feeders round out this pollinator sheltering space. Just a step beyond the rock garden, a small bridge flanked by formal native plantings, leads you to an arbor and a winding path through a meadow planting.

At the time I visited in early June, the meadow featured mixed-grass prairie species like little bluestem, side oats grama and prairie dropseed, with a smattering of wildflower blooms mixed in: common milkweed, penstemon, and baptisia. Several complementary non-natives like delphinium gave a nice pop of color as well.

The path curved around the back side of a rustic garden shed to a rare

wooded microclimate, which allows understory shrubs and woodland wildflower species to thrive.

Ron's many-layered meadow garden gives me hope as I grapple with my own yard, once shaded by an 80-year-old American Elm, but now baking in full sun. It's amazing what a gardener can accomplish over the years with a lot of persistence, creativity and grace.



Hop on the Botanical Bus: we're going to Kansas City!

Wednesday, September 21, 2022
7:45 a.m. to 6 p.m.

Join us for an excursion to a couple of horticultural havens in and around Kansas City, Kansas, while gaining great ideas for your home landscaping. Our first stop will be at Extension Master Gardener Lenora Larson's 27-acre home oasis. Long Lips Farm is a butterfly and sculpture garden in rural Paola. Her landscape is NABA (North American Butterfly Association), Monarch Waystation, and National Wildlife Federation certified and endorsed as a model pollinator garden by the Xerces Society for Invertebrate Conservation.

After lunch at the local favorite Timbercreek Bar and Grill, our second stop will be at Overland Park Arboretum and Botanical Gardens. Staff horticulturist Anne Wildeboor

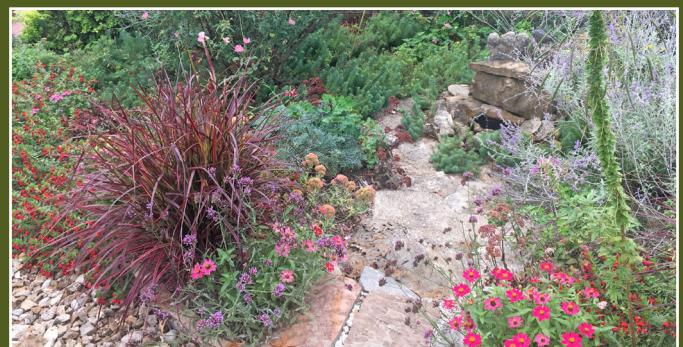

will give us a tour of her favorite horticultural features at the beautiful OPABG ranging from the wild to the manicured.

Lenora and Anne are entertaining and engaging botanical encyclopedias and the landscapes tour will be at the peak of their early fall splendor. Report to the Dyck Arboretum parking lot by 7:30. See our website or call (620) 327-8127 for fee information.



Hesston College
P.O. Box 3000
Hesston, KS 67062
620-327-8127
www.dyckarboretum.org
arboretum@hesston.edu



Address Service Requested

Non-Profit Org.
U.S. Postage
PAID
Hesston, KS
Permit No. 5

MEET OUR SUMMER INTERN!

Hello everyone! My name is Alex Mendoza, and I am the 2022 Summer Horticulture and Grounds Management Intern at the Dyck Arboretum! I am originally from a small town in Colorado called Parachute.

I have always enjoyed learning about nature, and I am excited to learn more about prairies as I have spent my whole life in the mountains.

Besides being outdoors, I enjoy reading and trying new food. A good taco is always appreciated.

I will be a sophomore at Bethel College this fall. I am studying Biology, with a minor in English. Feel free to stop and chat with me about any of these subjects if you see me working at the Arboretum!

If you or someone you know might be a good candidate for a Horticulture and Grounds Management Internship, please visit dyckarboretum.org/internship for more information. The application period for our 2023 summer internship will open up in January.



Staff

Scott Vogt, Executive Director/Horticulturist
Brad Guhr, Education/Prairie Restoration/
Concert Series Coordinator
Janelle Flory Schrock, Public Engagement
Coordinator
Katie Schmidt, Horticulturist/ Grounds Manager

Board of Trustees

Anthony Swartzendruber - Hesston (Chair)
Mark Diller - Hesston
Robert Dueck - Allen, TX (Vice-Chair)
Connor Dyck - Houston, TX
Lisa George - Hesston
Diane Gjerstad - Wichita
Monica Miller - Hesston
John Torline - North Newton
Joseph Uhlman - Sedgwick
NEW! Kim Witt - Canton
NEW! Mike Zucconi - Hesston

Established in 1981 by Harold and Elva Mae Dyck,
the Dyck Arboretum of the Plains is owned by

