

Dyck Arboretum of the Plains

# PrairieWindow

*to promote through education and stewardship, the conservation and use of plants native and adaptable to Kansas*



Spring 2015 Vol. 25 No 1

## Kansas Water Symposium on March 7

*by Brad Guhr, Education and Prairie Restoration Coordinator*

On Saturday, March 7, 2015, the Dyck Arboretum of the Plains will host its annual spring educational symposium on the theme of water. Participants will become more informed about the state of Kansas water, where we get it and how we use it, what it means to our livelihood and economy, and how well-prepared we are for the next drought cycle when it occurs. They will learn what conservation solutions are available for our agricultural systems, municipalities, and landscapes, and how important water is to our state's natural history and eco-tourism.

Water is critical to our survival. Kansans are fortunate to have developed an infrastructure to capture surface water in reservoirs in the eastern part of the state and tap into the Ogallala Aquifer in the western part. These systems have provided clean, plentiful, inexpensive water for decades and we tend to use it as if there is an endless supply. But as Kansas water usage increases, threats to our water supply and quality are ever more present.

Presenters will cover a variety of topics, beginning with the big picture perspective of "Drought Cycles over the Last 1,000 years" with Tony Layzell from Kansas Geological Survey and "Anticipated Effects of Drought" with KDHE watershed field coordinator Richard Basore. Bobbi Luttjohann, environmental scientist with the Kansas Water Office will present "Kansas Water 101" and Tim Boese, Equus Bed manager will present on water issues especially pertinent to South Central Kansas. Water conservation topics in the afternoon will feature KSU professor and agricultural engineer Danny Rogers ("Advances in Irrigation Technology"), director of utilities in Salina, Martha Tasker ("Municipality Water Conservation Solutions"), and Ross Braun from the KSU Horticulture Department ("Waterwise Solutions with Warm Season Grass Turf"). The day will finish with Joyce Wolf from Audubon of Kansas presenting "A Conservationist's View on Kansas Water."

Registration and a continental breakfast are at 8:30 a.m. followed by introductions at 8:50 a.m., and the day will end at 4 p.m. The cost is \$40 for arboretum members and \$50 for non-members and includes a full day of presentations, continental breakfast, and lunch.

Go to our website for more information about the speakers and schedule. To register, contact the Dyck Arboretum at 620-327-8127 or [arboretum@hesston.edu](mailto:arboretum@hesston.edu) by March 4.



## Go Green Leprechaun Run on March 14

On Saturday, March 14, 2015, Dyck Arboretum of the Plains will host its 5th Annual Go Green Leprechaun Run 2 mile fun run and 2nd annual 10K race. The 10K race starts at 8:30 a.m., with registration at 7:45 a.m. The 2 mile fun run starts at 10 a.m., with registration beginning at 9:15 a.m. Participants are invited to wear costumes and may win prizes for the following contest categories: The Color Green, Recycled/Repurposed Materials, and Most Irish.

Medals will be awarded to the top runners in age groups. See our website for details and a registration form. Sponsors include Atomic Sports, Excel Industries, Inc., GLC Real Estate, Kropf Lumber, Inc., Mid-Kansas Family Practice, Newton Medical Center, Waste Connections, Inc., and Road ID.



# Prairiestock Local Music Festival

Saturday, April 25, 2015 from 10 a.m. to 7 p.m.

Prairiestock is back! Our third year of this fun music festival will feature up to nine local artists from genres including acoustic guitar, Celtic, folk, jazz, Indie rock, bluegrass, and singer-songwriters. Bring a lawn chair or blanket, enjoy a rich variety of musical artists from Kansas, dine on tasty food vendor offerings, shop at our FloraKansas Native Plant Sale, and take in one act or a whole spring day at the arboretum! Admission: Adults \$5, Ages 18 and under FREE. If the weather doesn't cooperate, we'll move inside to the Prairie Pavilion. See the following list of participating artists and check our website for schedule updates.

Thor Bonner	Acoustic Guitar
Emily Strom	Jazz/Soul
Jammin' Biscuits	Bluegrass
Barry Jones	Singer-songwriter
Book of Jebb	Folk/Bluegrass
Knocknasheega	Celtic/Folk
The DeVeils	Folk/Indie Rock/Celtic
Delores and the Pickin'-Fretter	Accordian, Guitar, and Cello
Ne'erdowells	Acoustic/Roots/Rock



*Jammin' Biscuits*



*Emily Strom (Photo by AAH Photography)*

## Develop a Waterwise Garden at our Native Landscape Classes

Tuesday, March 24 (6:30-9 p.m.) or Saturday, April 11, (9:00-11:30 a.m.)

The days are getting longer and temperatures are beginning to warm. Spring is quickly approaching. Our thoughts turn to our gardens and landscapes. Spring is a time synonymous with flowers and renewal. Does your garden need renewal? Is your landscape water thirsty? Do you need advice to develop a plan for a low-maintenance, low-water landscape? Do you need ideas of plants to extend your landscape's seasonal interest?

Join Scott Vogt as he takes you through the process of planning, designing, installing and maintaining a native landscape. Come prepared with a scale drawing of your landscaping site. Attendees will receive an additional \$5 discount at our 2015 spring plant sale to purchase the plants from their design. Cost is \$20/person, \$15/Members. Call the arboretum for reservations.



*Once established, deep-rooted native plants survive without supplemental irrigation*



**2015 PLANT LIST**  
**FloraKansas: The Great Plains Plant Bazaar**  
**Dyck Arboretum of the Plains**

177 West Hickory, Hesston, KS 67062  
620-327-8127 • www.dyckarboretum.org • arboretum@hesston.edu

Funds generated from the sale of these plants help support our continuing mission: to promote through education and stewardship, the conservation and use of plants native and adaptable to Kansas.

The Arboretum maintains gardens and prairie plant collections for education and conservation, providing a natural setting for reflection and appreciation of nature.

**Plants**

	Non-Member Price	Member Price
Pot Size	(Each)	(Each)
2 ½" perennials and vines	\$3.95	\$3.55
4" perennials and vines	\$5.25	\$4.70
6" perennials and vines	\$12.00	\$10.80
6" Hostas	\$14.00	\$12.60
Proven Winner Shrubs	\$12.00	\$10.80
1 gallon trees & shrubs	\$12.00	\$10.80
2 gallon trees & shrubs	\$17.00	\$15.30
3-5 gallon trees	\$22.00	\$19.80

**Schedule - Spring Plant Sale**

**Members Only**

Thursday, April 23, 1 – 7 p.m.

**Public Sale**

Friday, April 24, 8 a.m. – 7 p.m.

Saturday, April 25, 8 a.m. – 5 p.m.

Sunday, April 26, Noon – 4 p.m.

Monday, April 27, 8 a.m. – 6 p.m.

**Exposure:** S=Sun    LtSh=Light Shade (3-6 hrs shade)    mSh=Medium Shade (7-8 hrs shade)    Sh=Shade (all day shade)  
**Soil:** W=Wet    M=Mesic-average garden soil    D=Dry

	Scientific Name	Common Name	Color	Height (")	Bloom	Exposure	Soil
<b>PERENNIALS</b>							
	Achillea 'Moonshine'	Yarrow	yellow	18-24	June-Aug	S	WM-MD
	Achillea millefolium 'Pomegranate'	Yarrow	red-purple	24-36	June-Aug	S	WM-MD
	Achillea millefolium 'Strawberry Seduction'	Yarrow	red	18-24	June-Aug	S	WM-MD
	'Saucy Seduction'	Yarrow	pink shades	18-24	June-Aug	S	WM-MD
	'Sunny Seduction'	Yarrow	lt yellow	18-24	June-Aug	S	WM-MD
	Achillea 'Terra Cotta'	Yarrow	peach	24-36	June-July	S	WM-MD
New!	Actaea pachypoda 'Misty Blue'	White Baneberry	white shades	24-36	May-June	mSh-Sh	WM-M
	Agastache foeniculum 'Golden Jubilee'	Golden Anise Hyssop	lavender	36	July-Sept	S	M-D
	Allium cernuum	Pink Nodding Onion	pink	10-20	July-Aug	S	WM-MD
	Allium stellatum	Prairie Onion	pink	10-20	July-Aug	S	M-D
	Amsonia 'Blue Ice'	Blue Star	blue	12-15	May-June	S-ltSh	WM-M
	Amsonia hubrechtii	Narrow Leaf Blue Star	blue	18-24	May-June	S-ltSh	WM-M
	Amsonia illustris	Shining Blue Star	blue	18-24	May-June	S-ltSh	WM-M
	Anemone canadensis	Meadow Anemone	white	12-18	May-June	S-ltSh	WM-M
	Aquilegia canadensis	Canadian Columbine	red/yellow	12-24	April-May	S-Sh	M-D
	'Corbett'	Yellow Wild Columbine	yellow	12-18	April-May	ltSh-Sh	M-MD
	Arisaema triphyllum	Jack-in-the-pulpit	green	8-12	April-May	Sh	WM-M
	Asarum canadense	Wild Ginger	red/brown	12	May-June	S	M-MD
	Asclepias exaltata	Poke Milkweed	white	48-60	June-July	ltSh-Sh	M-MD
	Asclepias incarnata 'Cinderella'	Red Swamp Milkweed	red	36-48	July-Sept	S	W-M
New!	Asclepias speciosa	Showy Milkweed	purple	36-48	June-Aug	S-ltSh	M-D
	Asclepias syriaca	Common Milkweed	pink	48-60	June-Aug	S	M-D
	Asclepias tuberosa	Butterfly Milkweed	orange	20-24	July-Aug	S-ltSh	M-D
	'Hello Yellow'	Yellow Butterfly Milkweed	yellow	20-24	June-Aug	S-ltSh	M-MD
	Aster cordifolius 'Avondale'	Wood Aster	lavender	18-24	Sept-Oct	ltSh-mSh	WM-MD
	Aster ericoides 'Snow Flurry'	Heath Aster	white	6-8	Sept-Oct	S	WM-MD
	Aster laevis	Smooth Blue Aster	blue	24-36	Aug-Oct	S-mSh	WM-MD
	Aster oblongifolius 'Dream of Beauty'	Aromatic Aster	pink	12 x 24	Sept-Oct	S	WM-MD
	'October Skies'	October Skies Aster	blue	18	Sept-Oct	S	WM-MD
	'Raydon's Favorite'	Aromatic Aster	blue	30-36	Oct-Sept	S	WM-MD
	Aster macrophyllus	Big-leaved Aster	white	12-15	Aug-Oct	ltSh-Sh	WM-D
	Aster sericeus	Silky Aster	purple	12	Sept-Oct	S-ltSh	MD-D
	Baptisia australis var. minor	Blue False Indigo	dark blue	15-24	April-June	S	M-MD
	Baptisia lactea	White Indigo	white	36-48	June-July	S	M-MD
	Baptisia 'Blueberry Sundae'	False Indigo	indigo blue	36	May-June	S	M-MD
	Baptisia 'Cherries Jubilee'	False Indigo	maroon/yellow	30-36	May-June	S	M-MD
	Baptisia 'Lemon Meringue'	False Indigo	lemon yellow	36	May-June	S	M-MD
	Baptisia 'Solar Flare Prairieblues'	Yellow Indigo	yellow-orange	24-36	May-June	S	WM-MD
	Baptisia 'Vanilla Cream'	False Indigo	pastel yellow	30-36	May-June	S	WM_MD
	Callirhoe alcaeoidea 'Logan Calhoun'	White Poppy Mallow	white	8-12	May-Aug	S	M-D
	Callirhoe involucrata	Purple Poppy Mallow	red/purple	6	June-July	S	M-D
	Ceanothus americanus	New Jersey Tea	white	24-36	May-June	S-ltSh	WM-MD
New!	Chrysogonum virginianum 'Superstar'	Green and Gold	yellow	6-8	May-June	ltSh-Sh	WM-M
	Clematis fremontii	Fremont's Clematis	blue	12-16	Apr-May	S	M-D
	Coreopsis tripteris	Tall Coreopsis	yellow	60-72	July-Oct	S-ltSh	WM-MD
	Dalea candida	White Prairie Clover	white	12-36	June-Sept	S	M-D
	Dalea purpurea	Purple Prairie Clover	purple	15-18	July-Aug	S	M-D
	Dodecatheon meadia 'Album'	White Shooting Star	white	24	Apr-May	S-ltSh	WM-MD
	'Aphrodite'	Pink Shooting Star	pink	20	May-June	S-ltSh	WM-MD
	Echinacea angustifolia	Narrow Leaf Coneflower	pink	18	May-June	S	M-D
	Echinacea pallida	Pale Coneflower	pink	36-48	June-July	S	M-D
	Echinacea paradoxa	Yellow Coneflower	yellow	24-48	June-Aug	S	M-D
	Echinacea purpurea 'Rubinstern'	Ruby Star Coneflower	red	36-42	July-Sept	S-ltSh	WM-MD
	Echinacea purpurea 'White Swan'	White Coneflower	white	24-36	June-Sept	S-ltSh	WM-MD
	Eryngium yuccifolium	Rattlesnake Master	white	36-48	July-Sept	S	WM-MD

*Perennials - Cont.*

	Eupatorium purpureum 'Gateway'	Joe Pye Weed	red	72	July-Sept	S	WM-M
New!	Eupatorium 'Phantom'	Dwarf Joe Pye Weed	mauve pink	24-36	July Sept	S-ltSh	WM-M
	Filipendula rubra 'Venusta'	Queen of the Prairie	pink	48	May-Aug	S-ltSh	W-M
	Geranium maculatum	Wild Geranium	lavender	12-24	Apr-June	ltSh-Sh	M-MD
	Geum triflorum	Prairie Smoke	red	12-15	April-June	S-ltSh	WM-D
	Hymenoxys scaposa 'Prairie Sunshine'	Plains Hymenoxys	yellow	8	May-July	S	M-MD
	Iris cristata	Crested Iris	blue	6	May-June	mSh-Sh	WM-M
New!	Iris fulva	Copper Iris	copper	18-30	May-June	S-mSh	WM-M
	Iris versicolor	Blue Flag Iris	blue	18	May-June	S-Sh	W-M
New!	Iris virginica	Southern Blue Flag	blue	12-30	May-June	S-ltSh	S-M
	Liatris aspera	Button Blazing Star	purple	24-36	July-Oct	S	M-D
New!	Liatris ligulistylis	Meadow Blazing Star	purple	48-60	Aug-Sept	S-ltSh	WM-MD
	Liatris punctata	Gayfeather	purple	12-24	July-Sept	S	M-D
	Liatris pycnostachya	Kansas Gayfeather	purple	30-50	July-Aug	S	W-M
	Liatris spicata 'Alba'	White Marsh Blz Star	white	36	July-Aug	S	W-M
	'Floristan Violet'	Violet Marsh Blazing Star	violet	36-60	July-Aug	S-ltSh	W-M
	Linum perenne	Blue Flax	blue	15-18	May-Aug	S-ltSh	M-D
	'Sapphire'	Blue Flax	blue	10	May-Aug	S	M-D
	Lobelia cardinalis 'Black Truffle'	Cardinal Flower	red	24-40	June-Sept	S	W-M
	Lobelia siphilitica 'Blue Select'	Great Blue Lobelia	blue	24	July-Aug	S-mSh	W-M
	Monarda fistulosa	Wild Beebalm	pink	36-48	June-Aug	S-ltSh	WM-MD
	Oenothera macrocarpa	Evening Primrose	yellow	8-10	May-Sept	S	M-D
New!	mac. 'Comanche Campfire'	Evening Primrose	yellow	12-15	May-Sept	S	MD-D
	Parthenium integrifolium	Wild Quinine	white	24-36	June-Sept	S-mSh	M-MD
	Penstemon cobaea	Cobaea Beardtongue	white	9-15	May-June	S	M-D
	Penstemon digitalis 'Husker Red'	Smooth Penstemon	white/pink	24-36	May-June	S-ltSh	M-MD
	Penstemon grandiflorus	Shell-leaf Penstemon	lavender	24-36	May-June	S	MD-D
	'War Axe'	War Axe Penstemon	pink/purple	18-24	May-June	S	MD-D
	Phlox divaricata	Woodland Phlox	blue	10-12	April-May	ltSh-Sh	WM-MD
	'Louisiana Blue'	Woodland Phlox	dark blue	10-12	April-May	ltSh-mSh	WM-M
	Phlox pilosa 'Eco Happy Traveler'	Prairie Phlox	pink	15-18	May-July	S-ltSh	WM-D
	Podophyllum peltatum	Mayapple	white	15-18	April-May	Sh	WM-MD
	Polygonatum biflorum	Great Solomon Seal	white	24	April-May	Sh	WM-MD
New!	Rudbeckia fulgida var. umbrosa	Orange Coneflower	dark yellow	20-30	Aug-Sept	S-mSh	WM-M
	Rudbeckia maxima	Giant Black-eyed Susan	yellow	60-84	May-July	S	WM-M
	Rudbeckia missouriensis	MO Black-eyed Susan	yellow	12-18	June-Aug	S	WM-MD
	Rudbeckia subtomentosa 'Little Henry'	Sweet Coneflower	yellow	36	Aug-Sept	S-ltSh	WM-M
	Rudbeckia triloba	Brown-eyed Susan	yellow	24-48	Aug-Oct	S-ltSh	WM-MD
	Salvia azurea	Blue Sage	blue	36-48	Aug-Sept	S	M-D
	Scutellaria resinosa 'Smoky Hills'	Resinous Skullcap	purple	6-12	May-July	S	M-D
	Silene regia	Royal Catchfly	red	24-40	July-Aug	S-ltSh	M-MD
	Silphium integrifolium	Rosin Plant	yellow	48-60	July-Sept	S-ltSh	WM-D
	Silphium laciniatum	Compass Plant	yellow	48-96	July-August	S	WM-MD
	Silphium perfoliatum	Cup Plant	yellow	48-96	July-Aug	S-ltSh	WM-M
	Silphium terebinthinaceum	Prairie Dock	yellow	36-72	August-Sept	S	WM-MD
	Solidago canadensis 'Golden Baby'	Gldn Baby Goldenrod	yellow	18-24	Aug-Oct	S	WM-MD
New!	Solidago caesia	Wreath Goldenrod	yellow	24-36	Aug-Oct	ltSh-mSh	WM-MD
New!	Solidago drummondii	Cliff Goldenrod	yellow	15-18	Aug-Aug	S-ltSh	WM-MD
	Solidago nemoralis	Gray Goldenrod	yellow	12-36	Aug-Oct	S-ltSh	M-D
New!	Solidago riddellii	Riddell's Goldenrod	yellow	30-36	Aug-Oct	S	W-M
	Solidago rigida	Stiff Goldenrod	yellow	36-60	Aug-Oct	S	WM-D
	Solidago ulmifolia	Elm-leaf Goldenrod	yellow	36	July-Oct	mSh-Sh	M-MD
	Stylophorum diphyllum	Yellow Wood Poppy	yellow	15	May-July	Sh	WM-MD
New!	Thalictrum dasycarpum	Purple Meadow Rue	cream	48-72	June-July	ltSh-MSh	WM-M
	Thalictrum dioicum	Early Meadow Rue	green	24	April-May	ltSh-mSh	WM-MD
	Tradescantia ohiensis	Ohio Spiderwort	blue	30-36	May-July	S-ltSh	WM-MD
	Tradescantia tharprii	Shortstem Spiderwort	purple	8-18	March-Apr	S	MD-D
	Verbena canadensis	Rose Verbena	purple/pink	8-18	March-Oct	S	M-D
	Verbena hastata	Blue Vervain	blue	36-48	July-Sept	S-ltSh	W-M
	Vernonia lettermanii 'Iron Butterflies'	Letterman's Ironweed	purple	30-36	Sept-Oct	S-ltSh	M-MD
	Veronicastrum virginicum 'Lavender Towers'	Culver's Root	lavender	36-72	June-Aug	S-ltSh	WM-MD
	Yucca glauca	Soapweed	white	36-48	June-Aug	S	M-D
	Zizia aptera	Heart-leaved Golden Alexander	yellow	18-24	April-May	S-mSh	WM-MD
	Zizia aurea	Golden Alexander	yellow	24-36	April-June	S-ltSh	WM-MD

## FERNS

	Athyrium 'Godzilla'	Giant Japanese Painted Fern	Silver/purple fronds	30-36	June-Sept	mSh-Sh	WM-M
New!	Athyrium niponicum 'Pictum'	Japanese Painted Fern	Purple fronds	12-24	June-Sept	mSh-Sh	WM-M
	Dryopteris erythrosora	Autumn Fern	Copper fronds	24-30	June-Oct	mSh-Sh	WM-M

## GRASSES

	Andropogon gerardii 'Pawnee'	Pawnee Bluestem	grass	60-72	July-Oct	S	WM-D
	'Indian Warrior'	Indian Warrior Big Bluestem	grass	60-72	July-Oct	S	WM-MD
	Bouteloua gracilis 'Blonde Ambition'	Golden Blue Grama	grass	12-24	Aug-Oct	S	WM-D
New!	Calamagrostis acutiflora 'Avalanche'	Variegated Feather Reed Grass	grass	48-60	Aug-Oct	S	WM-MD
	Calamagrostis acutiflora 'Karl Foerster'	Feather Reed Grass	grass	48-60	August	S-ltSh	WM-MD
	Calamagrostis acutiflora 'Overdam'	Variegated Feather Reed Grass	grass	48-60	Aug-Oct	ltSh-mSh	WM-MD
	Calamagrostis brachytricha	Korean Feather Reed Grass	grass	36-48	Aug-Oct	ltSh-mSh	WM-MD
	Carex amphibola	Creek Sedge	sedge	12	Aug-Oct	S-mSh	WM-MD
	Carex cburnea	Bristleleaf Sedge	sedge	6	Aug-Oct	ltSh-Sh	WM-MD
	Carex grayi	Common Bur Sedge	sedge	24-36	Aug-Oct	S-Sh	W-M
New!	Carex siderosticha 'Snow Cap'	White-leaved Sedge	sedge	6-8			
	Carex sprengeii	Long-beaked Sedge	sedge	24	May-Oct	ltSh-Sh	SM-MD
	Chasmanthium latifolium	Northern Sea Oats	grass	36	Aug-Oct	S-Sh	WM-MD
	Eragrostis tricooides	Sand Love Grass	grass	36-48	Aug-Oct	S	M-MD
	Hystrix patula	Bottlebrush Grass	grass	24-36	Aug-Oct	ltSh-Sh	M-MD
	Koeleria pyramidata	Junegrass	grass	12-18	May-June	S	WM-MD
New!	Miscanthus sinensis 'Oktoberfest'	Miscanthus	grass	72-84	Aug-Oct	S-ltSh	WM-MD
	Molina arundinacea 'Skyracer'	Tall Moor Grass	grass	72-84	June-Oct	S-ltSh	WM-MD
New!	Muhlenbergia reverchonii 'Undaunted'	Ruby Muhly Grass	grass w/ red bloom	15-18	Aug-Oct	S-ltSh	Wm-MD

Grasses - Cont.

	Panicum virgatum 'Cheyenne Sky'	Red switchgrass	grass	24-36	June-Oct	S	WM-MD
	'Dallas Blues'	Blue Switchgrass	grass	48-70	July-Oct	S	WM-D
	'Northwind'	Upright Switchgrass	grass	48-60	July-Oct	S	WM-MD
	Pennisetum 'Desert Plains'	Fountain Grass	grass	36-48	June-Oct	S	WM-MD
	'Little Bunny'	Miniature Fountain Grass	grass	6-12	Aug-Sept	S	WM-MD
	'Red Head'	Red Head Fountain grass	grass	36-48	June-Oct	S	WM-MD
	Schizachyrium scoparium 'Blaze'	Blaze Little Bluestem	grass	12-24	July-Oct	S	M-D
	'Blue Heaven'	Blue Heaven Little Bluestem	grass	42-54	July-Oct	S	WM-D
New!	'Smoke Signal'	Little Bluestem	grass	36-48	July-Oct	S	WM-MD
	'Standing Ovation'	Upright Little Bluestem	grass	36-48	July-Oct	S	WM-D
New!	'Twilight Zone'	Silver Little Bluestem	grass	48-52	July-Oct	S	WM-MD
	Sorghastrum nutans	Indiangrass	grass	48-60	July-Oct	S	WM-D
	Sporobolus heterolepis	Prairie Dropseed	grass	12	June-Oct	S-ltSh	WM-D
New!	Stipa calamagrostis	Pheasant Tail Grass	grass	30-40	June-Sept	S-ltSh	WM-MD

## SHRUBS

	Amelanchier canadensis 'Glennform'	Rainbow Pillar Serviceberry	white	20' X 8-10'	April-May	ltSh-mSh	WM-M
	Amelanchier x grandiflora 'Autumn Brilliance'	Serviceberry	white	10'-15'X10'-15'	April-May	ltSh-mSh	WM-M
	Amorpha canescens	Leadplant	purple	24-36	June-July	S	M-D
	Amorpha nana	Fragrant False Indigo	purple	12-36	May-June	S	M-D
	Aronia melanocarpa 'Morton'	Iroquois Beauty Black Chokeberry	white fl w/blk fruit	24-48	May-June	S-mSh	WM-M
	Aronia melanocarpa 'Viking'	Viking Chokeberry	white fl w/blk fruit	36-60	May-June	S-mSh	WM-M
	Buddleia x Lo & Behold 'Blue Chip'	Blue Chip Butterfly Bush	lavender	24-30	June-Sept	S	M
	Lo & Behold 'Ice Chip'	Ice Chip Butterfly Bush	white	18-24	June-Sept	S	M
	Lo & Behold 'Lilac Chip'	Lilac Chip Butterfly Bush	lavender-pink	18-24	June-Sept	S	M
	Lo & Behold 'Pink Micro Chip'	Dwarf Butterfly Bush	pink	18-24	June-Sept	S	M-
	Lo & Behold 'Purple Haze'	Purple Haze Butterfly Bush	dark purple	24-36	June-Sept	S	MNew
	Callicarpa americana	American Beautyberry	purple fruit	36-48	Fall Fruit	S-ltSh	WM-M
New!	Caryopteris 'Beyond Midnight'	Beyond Midnight™ Bluebeard	blue/purple	24-30	Aug-Oct	S	M-MD
	'Janice'	Lil' Miss Sunshine Bluebeard	blue	24-36	Aug-Oct	S	M-MD
	'Minibleu', 'Petit Bleu'	Compact Bluebeard	blue	20-24	Aug-Oct	S	M-MD
	Caryopteris incana 'Sunshine Blue'	Golden Bluebeard	blue	36	Aug-Sept	S	M-MD
	Cephalanthus occidentalis	Buttonbush	white	72-84	July-Aug	S-ltSh	W-M
	'Sugar Shack'	Buttonbush	white	36-48	July-Aug	S-ltSh	W-M
New!	Cornus obliqua 'Powell Gardens'	Red Rover™ Silky Dogwood	white	48 X 60	May	S-mSh	WM-M
	Corylus americana Sun Harvest'	Sun Harvest Filbert	brown	72-96	April	S-ltSh	WM-MD
	Cotinus 'Ancot'	Golden Spirit™ Smokebush	pink	72-96	June-July	S-mSh	WM-M
	'Grace'	Grace Smokebush	pink	15' X 8'	June-July	S-ltSh	WM-MD
	'Young Lady'	Young Lady Smokebush	tan/green	8' X 8'	June-Sept	S-ltSh	WM-MD
	Fallugia paradoxa	Apache Plume	pink	48-60	May-Sept	S	M-MD
	Hamamelis vernalis	Vernal Witchazel	yellow	72-120	Jan-Feb	S-mSh	WM-MD
	Heptacodium miconioides	Seven Son Flower	white	10-15'	Aug-Oct	S-ltSh	WM-M
	Hydrangea arborescens 'Abetwo'	Incrediball Hydrangea	white	48-60	June-Sept	ltSh-mSh	WM-M
New!	Hydrangea paniculata 'ILVOBO'	Bobo® Hardy Hydrangea	white	30 X 48	June-Aug	ltSh-mSh	WM-M
	Hydrangea quercifolia	Oakleaf Hydrangea	white	48-72	May-June	ltSh-Sh	WM-M
New!	'Gatsby's Gal'	Gatsby's Gal Oakleaf Hydrangea	white	48-60	June-Aug	ltSh-Sh	WM-M
New!	'Gatsby's Moon'	Double Oakleaf Hydrangea	white	48-60	June-Aug	ltSh-Sh	WM-M
New!	'Gatsby's Pink'	Pink Oakleaf Hydrangea	pink	72	June-Aug	ltSh-Sh	WM-M
	'Gatsby's Star'	Star Oakleaf Hydrangea	white	48-60	June-Aug	ltSh-Sh	WM-M
	'Little Honey'	Golden Oakleaf Hydrangea	white flws w/ red FC	36-48	June-Aug	ltSh-Sh	WM-M
New!	'Munchkin'	Dwarf Oakleaf Hydrangea	white	36 x 48	June-Aug	ltSh-Sh	WM-M
	'Ruby Slippers'	Ruby Blooming Hydrangea	ruby	36	June-Aug	ltSh-Sh	WM-M
	'Sikes Dwarf'	Dwarf Oakleaf Hydrangea	white	36-48	June-Aug	ltSh-Sh	WM-M
	'Snow Queen'	Snow Queen Oakleaf Hydrangea	white	7-8'	June-Aug	ltSh-Sh	WM-M
New!	Lagerstromieia 'G2X-13314'	Infinitini™ Brite Pink Crapemyrtle	pink	24-48	June-Sept	S	WM-MD
New!	'G2X-13327-1'	Infinitini™ Magenta Crapemyrtle	magenta	24-48	June-Sept	S	WM-MD
New!	'G2X-13225-1'	Infinitini™ Orchid Crapemyrtle	lavender	24-48	June-Sept	S	WM-MD
	Lagerstromieia indica 'Whit 2'	Dynamite® Crapemyrtle	true red	24-48	July-Sept	S	M-MD
	'Whit 3'	Pink Velour® Crapemyrtle	flashy pink	24-48	July-Sept	S	M-MD
	'Whit 4'	Red Rocket® Crapemyrtle	cherry red	24-48	July-Sept	S	M-MD
	'Whit 7'	Siren Red® Crapemyrtle	dark red	24-48	July-Sept	S	M-MD
	'Whit 9'	Double Feature® Crapemyrtle	wine red	24-48	July-Sept	S	M-MD
	Lindera benzoin	Spicebush	red fruit ylw FC	6-12'	July-Oct	S-mSh	WM-M
	Physocarpus opulifolius 'Coppertina'	Copper Ninebark	white	60-96	May-June	S-ltSh	WM-M
	'Center Glow'	Center Glow Ninebark	white	60-96	May-June	S-ltSh	WM-M
	'Festivus Gold'	Golden Ninebark	white	48-60	May-June	S-ltSh	WM-M
	'Little Devil'	Little Devil Ninebark	white	36-48	May-June	S-ltSh	WM-M
	'Summer Wine'	Summer Wine	white	60-72	May-June	S-ltSh	WM-M
New!	'Tiny Wine'	Dwarf Ninebark	white	36-48	May-June	S-ltSh	WM-M
	Prunus besseyi 'Pawnee Buttes'	Western Sand Cherry	white	12-15	May-June	S	M-MD
	Rhus aromatica 'Gro-Low'	Gro-Low Fragrant Sumac	yellow	24-48	May-June	S-ltSh	WM-MD
	Rhus typhina 'Tiger Eyes'	Tiger Eyes Ctlf Sumac	yellow leaves	60-72	Aug-Sept	S-ltSh	WM-MD
	Ribes odoratum 'Crandall'	Clove-scented Currant	yellow	36-60	April-May	ltSh-mSh	WM-M
	Rosa 'BALrage'	All the Rage Rose	coral apricot	24-48	April-Sept	S-ltSh	WM-MD
	'Home Run'	Home Run Rose	dark red	36-48	May-Oct	S-ltSh	WM-MD
	'Pink Home Run'	Pink Home Run Rose	pink	36-48	May-Oct	S	WM-MD
	Sambucus canadensis 'Adams'	Adams Elderberry	white	72-120	June-July	S-mSh	W-M
	'York'	York Elderberry	white	72-120	June-July	S-mSh	W-M
	Sambucus nigra 'Eva'	Black Lace™ Elderberry	white/pink	6-8'	June-July	S-mSh	WM-M
New!	Sambucus racemosa 'SMNSRD4'	Lemony Lace™ Elderberry	white	36-60	June-July	S-mSh	WM-M
	Salix chaenomeloides 'Mt. Asama'	Pink Pussy Willow	pink	8-10' X 8-10'	April-May	S-ltSh	W-M
New!	Spirea japonica 'SMSMBK'	Double Play® Blue Kazoo®	white	24-36	May-June	S-ltSh	WM-M
New!	'SMNSJMFP'	Double Play® Pink	pink	24-36	May-June	S-ltSh	WM-M
New!	'SMNSJMFR'	Double Play® Red	red	24-36	May-June	S-ltSh	WM-M
	Syringa x 'Penda'	Bloomerang Lilac	repeating purple	48-60	May, June-Sept	S-ltSh	WM-M
	Syringa x 'SMSJBP7'	Bloomerang Dark Purple Lilac	repeating dk purple	48-72	May-Sept	S-ltSh	WM-M
	Syringa x 'SMSXPM'	Scent and Sensibility™ Pink Lilacpink	24-36	May-Sept	S-ltSh		WM-M
New!	Viburnum 'NCVX1'	Shiny Dancer™ Viburnum	white	36-60	May-June	S-ltSh	WM-M
New!	Viburnum bracteatum 'SMVDLS'	All That Glitters™ Viburnum	white	48-60	May-June	S-mSh	WM-M



# Help the Monarch Butterfly by Planting Milkweed Species

By Scott Vogt, Executive Director/Horticulturist

*"Monarch butterfly populations are declining due to loss of habitat. To assure a future for monarchs, conservation and restoration of milkweeds needs to become a national priority."*

*- Chip Taylor, Director, Monarch Watch*

The data are staggering. Monarch butterfly populations overwintering in Mexico dropped 59 percent in 2013. Monarchs migrate from the United States and Canada to spend the winter in mountaintop fir forests in central Mexico. After declines six of the last seven years, there are now only one-fifteenth as many butterflies as there were in 1997.

This decline can be attributed to a variety of factors, including the loss of their host plant, milkweeds. Monarchs are eternally connected to milkweeds. It is said that monarchs can smell a nectar source from up to two miles away. Their offspring, the emerging caterpillars, feed exclusively on the leaves of milkweeds. The incredible metamorphosis from a caterpillar to an emerging adult monarch butterfly can only happen after devouring milkweed leaves. The monarch caterpillars ingest the milky sap from the leaves making them unsavory to predators. This delicate life cycle is amazing.

So what can you do to help stem the tide of this devastating population decline? You can support the monarch populations by planting milkweeds and other nectar plants in your landscape. Here are several species that Monarch Watch recommends:

1. Butterflyweed (*Asclepias tuberosa*): King of our native milkweeds and a monarch magnet. The bright orange color makes it one of the most recognizable wildflowers in the prairie. It blooms during the hottest part of the year from June to August. Plant in full sun and medium, well-drained soil. Grows 18-24" tall. Variety 'Hello Yellow' has bright yellow blooms.
2. Common milkweed (*Asclepias syriaca*): A buffet for monarchs. The fragrant pink blooms develop in June and July attracting a host of pollinators. Be aware! It will spread, so give it a home where it can roam. Full sun, grows 24-48" tall.
3. Swamp milkweed (*Asclepias incarnata*): Thrives in wetter conditions. The soft pink blooms appear in late summer as monarchs migrate south. Plant it in full sun. 3-5' tall. 'Ice Ballet' is a variety with white flowers.
4. Showy milkweed (*Asclepias speciosa*): It is similar to common milkweed, but with larger pinkish-purple flowers. The wide leaves are excellent food for monarchs. Give it space to roam, because it spreads by underground rhizomes and will take over small landscape plantings. Full sun, 24-48" tall.

Other nectar plants monarchs prefer: 5. Blazing star (*Liatriis* sp.), 6. Goldenrod (*Solidago* sp.), 7. Aster (*Aster* sp.), 8. Black-eyed susan (*Rudbeckia* sp.), 9. Wild bergamot (*Monarda* sp.), and 10. Coneflower (*Echinacea* sp.).



*Monarch caterpillar*





# A Waterwise Native Landscape Planting Design

By Scott Vogt, Executive Director/Horticulturist

For over 30 years, the arboretum has promoted the use of native and adaptable plants in the landscape. Our mission encourages stewardship and conservation. These tenets are the main reasons waterwise gardening is gaining in popularity. A waterwise landscape can simply be defined as an environmental design that minimizes the need for water. It should be our goal to develop a landscape that uses less water, saves money, requires less work, and creates a beautiful display throughout the year.

It can be tough gardening in Kansas. The unrelenting wind coupled with summer temperatures can stress even the hardiest plants. Native plants still deliver. Their deep roots and leaf adaptations make them durable and drought tolerant. Here are the elements of a successful waterwise garden.

**Matching plants to our climate** is the most important goal in establishing and maintaining a waterwise garden. Anytime you stray too far from this goal, the plants don't flourish and they require more care and water.

**Group plants according to their water needs.** Evaluate your amount of sun/shade and soil type. Choose plants that will thrive in the microclimate of your yard. Sun-loving native plants need at least six hours of direct sunlight to grow happily. Otherwise, look at more shade-loving species.

**Irrigate efficiently by putting water where the plants need it.** We use drip irrigation because very little water is lost through evaporation. Overhead sprinklers can be used but focus their use early in the morning or later in the evening. Avoid the mid to late afternoon because more water is lost to evaporation and wind during this time.

**Apply at least two inches of mulch to landscape plantings.** Mulch keeps the soil at a more even temperature, controls erosion, reduces water loss through evaporation, and helps control weeds. Too much mulch can have an adverse effect on wildflowers and grasses. Keep mulch at least 3-4 inches away from the crowns or main stems of the plants.

**Increase the organic matter in your soil.** Clay soils are often either too wet or too dry. Improving the soil by incorporating organic matter such as compost, leaves, and cotton burr compost will increase the soil water-holding capacity and fertility. Don't go overboard, because too much fertility causes other problems. Sandy soils benefit from organic matter as well.

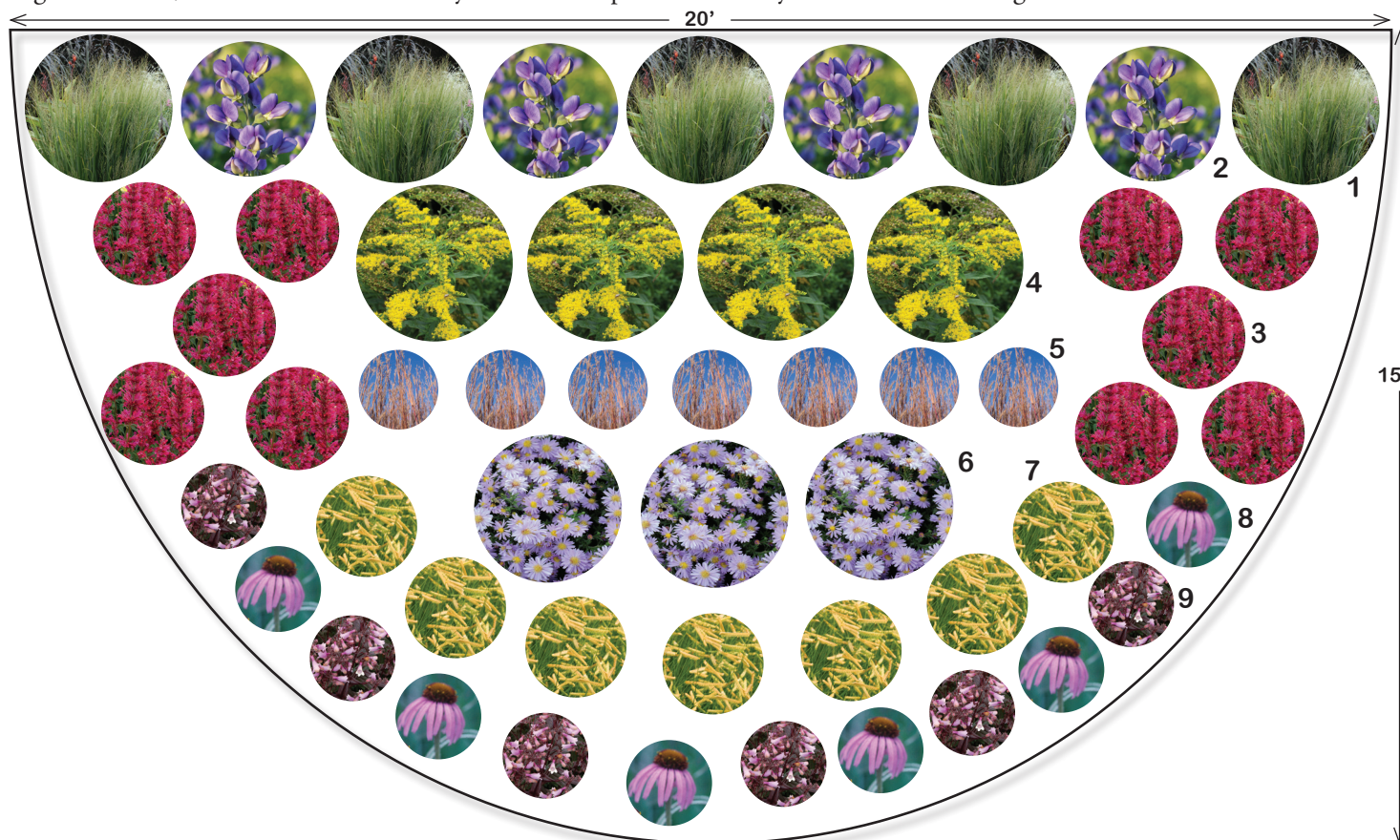

LEGEND: 1. *Panicum* 'Northwind'; 2. *Baptisia* 'Blueberry Sundae'; 3. *Agastache* 'Raspberry Summer'; 4. *Solidago* 'Fireworks'; 5. *Schizachyrium scoparium* 'Twilight Zone'; 6. *Aster* KICKIN® 'Lavender'; 7. *Bouteloua* 'Blonde Ambition'; 8. *Echinacea angustifolia*; 9. *Penstemon* 'Dark Towers'; (\*More information about these species can be found in the plant list.)

Other designs at [dyckarboretum.org/landscaping-with-native-plants/](https://dyckarboretum.org/landscaping-with-native-plants/)

## Shrubs - Cont.

New!	‘SMVDBL’	All That Glows™ Viburnum	white	48-60	May-June	S-mSh	WM-M
New!	Viburnum carlesii ‘Spice Ball’	Fragrant Viburnum	white	36-60	May-June	S-mSh	WM-M
New!	Viburnum cassinoides ‘SMNVCCDD’	Lil’ Ditty™ Viburnum	white	12-24	May-June	S-mSh	WM-M
	Viburnum dentatum ‘Blue Muffin’	Blue Muffin Viburnum	white	5’ X 7’	May	S-mSh	WM-M
	Viburnum dilatatum ‘Henneke’	Cardinal Candy Viburnum	white	5’ X 7’	May	S-mSh	WM-M
	Viburnum prunifolium	Blackhaw Viburnum	white	8’ X 12’	May-June	S-ltSh	WM-M
	Viburnum x rhytidophyloides ‘Allegheny’	Leather-leaf Viburnum	white	8’ X 10’	May-June	S-ltSh	WM-M
	‘Dart’s Duke’	Leather-leaf Viburnum	white	6’ X 8’	May-June	S-mSh	WM-M
	‘NCVR’ Emerald Envy™	Lantanaphyllum Viburnum	white shades	6’ X 8’	May-June	S-mSh	WM-M
	‘Redell’	Red Balloon Viburnum	white	6-8’ X 6-8’	April-May	S-ltSh	WM-MD
	Viburnum rufidulum	Rusty Blackhaw Viburnum	white	10’ X 20’	May-June	S-lt Sh	WM-MD

## VINES

	Bignonia capreolata	Cross Vine	re/orange	vine	May-June	S-ltSh	WM-M
	Celastrus scandens ‘Bailumn’	Autumn Revolution Bittersweet	fall red berries	vine	Aug-Oct	S-Sh	WM-MD
New!	Clematis ‘Climador’	Purple Clematis	purple	vine	June-Sept	S-ltSh	WM-M
New!	Clematis ‘Happy Jack’™	Purple Clematis	purple	vine	July-Sept	S-ltSh	WM-M
New!	Clematis ‘Pink Mink’	Pink Mink Clematis	pink	vine	July-Sept	S-ltSh	WM-M
New!	Clematis ‘Sweet Summer Love’	Sweet Summer Love Clematis	red/violet	vine	Aug-Sept	S-ltSh	WM-M
	Hydrangea petiolaris	Climbing Hydrangea	white	vine	June-July	S-Sh	WM-M
	Lonicera reticulata ‘Kintzley’s Ghost’	Grape Honeysuckle	yellow	vine	May	S-ltSh	WM-MD
	Lonicera sempervirens ‘Major Wheeler’	Trumpet Honeysuckle	red	vine	May-Aug	S-mSh	WM-M
	Vitis coignetiae	Crimson Glory Vine	brilliant red fall color	vine	Sept-Oct	S-mSh	WM-M
New!	Wisteria Blue Moon’	Kentucky Wisteria	blue	vine	June	S-mSh	WM-M

## TREES

	Acer saccharum	Sugar Maple	red/orange FC	50’ X50’	Oct-Nov	S-mSh	WM-M
	Acer saccharum ‘Apollo’	Upright Maple	w/red fall color	30’ X 25’	Oct-Nov	S-mSh	WM-M
	Amelanchier arborea	Downy Serviceberry	white	15’ X 15’	April-May	ltSh-mSh	WM-M
New!	Amelanchier x grandiflora ‘Robin Hill’	Robin Hill Serviceberry	white	20’ X 12’	April-May	ltSh-mSh	WM-M
	Asimina triloba	Pawpaw Tree	brown	20’	April-May	S-Sh	WM-MD
	Betula nigra ‘Dura Heat’	Dura Heat River Birch	exfoliating bark	20’ X 20’	Oct-Nov	S-ltSh	W-M
	Carya illinoensis	Pecan	edible fruit	70’ X 50’	Sept-Nov	S-mSh	W-M
	Cercis canadensis	Redbud	pink	20’-30’ X 25-35’	April-May	S-mSh	WM-MD
	Cladrastis kentuckea	Yellowwood	white	30’-40’X 30’-40’	May	S-ltSh	WM-M
New!	Diospyros virginiana	Persimmon	cream	40’ X 25’	May-June	S-mSh	WM-MD
	Ostrya virginiana	Ironwood	white	30-50’ x 25’		S-mSh	WM-M
	Pinus ridida x taeda	Pitch Loblolly Pine		40’ X 30’		S-ltSh	M-MD
	Populus tremuloides ‘NE-Arb’	Prairie Gold Quaking Aspen	golden yellow fall color	30’ X 15’		S-ltSh	WM-M
	Quercus alba	White Oak	red fall color	60-80’ X 60-80’		S-ltSh	WM-MD
	Quercus macrocarpa	Bur Oak	great shade tree	60-80’ X 60-80’		S-ltSh	WM-MD
New!	Quercus pagodifolia	Cherrybark Oak	good FC	50’ X 30’		S-ltSh	WM-MD
	Quercus stellata	Post Oak	nice FC	40’ X 40’		S-ltSh	M-MD
New!	Quercus imbricaria	Shingle Oak	nice FC	60’ X 50’		S-ltSh	M-MD
New!	Sassafras albidum	Sassafras	nice FC	30’ X 25’	Oct-Nov	ltSh-mSh	M-MD
	Taxodium distichum	Bald Cypress	orange FC	50’ X 30’	Oct-Nov	S-ltSh	WW-M
	Tilia americana	American Linden	yellow FC	60-75’ X 40’		S-ltSh	WM-M

## TEMPERENNIALS

	Aristolochia littoralis ‘Elegans’	Dutchman’s Pipe	maroon	12’	June-Aug	S-ltSh	M-M
	Asclepias curassavica	Bloodflower	orange-red	36	June-Oct	S-ltSh	WM-M
New!	Coleus Color Clouds™ ‘Hottie’	Coleus	lime green lvs w/ magenta veins	10	May-Oct	ltSh-Sh	WM-M
New!	Coleus Color Clouds™ ‘Cuckoo’	Coleus	red leaves w/ golden edge	12-16	May-Oct	lSh-Sh	WM-M
	Colocasia esculenta ‘Black Cora’	Royal Hawaiian Elephant Ears	purple leaves	36-60		S-ltSh	M-MD
	Colocasia gigantea ‘Thailand Giant’	Thailand Giant Elephant Ears	large leaves	9’		S-lt Sh	M-MD
	Gaillardia aristata ‘Arizona Red Shades’	Blanket Flower	red	10-12	May-Sept	S	M-MD
	‘Arizona Apricot’	Blanket Flower	yellow/orange	12	June-Oct	S	M-MD
	‘Fanfare Blaze’	Blanket Flower	fluted red	12-16	June-Oct	S	M-MD
	Pennisetum setaceum rubrum ‘Fireworks’	Purple Fountain Grass	grass	24-30	July-Sept	S-ltSh	WM-M
	Salvia elegans ‘Golden Delicious’	Pineapple Sage	red	36-48	June-Sept	S	WM-MD
	Salvia farinacea ‘Evolution’	Purple Sage	deep-violet	18	June-Sept	S	WM-MD
	Salvia greggii ‘Raspberry Royale’	Raspberry Sage	raspberry-wine	18-24	June-Sept	S	WM-MD

## ADAPTABLE PERENNIALS

	Agastache ‘Blue Boa’	Hummingbird Mint	violet blue	24-30	June-Sept	S	M-MD
New!	Agastache ‘Kudos Amborasia’	Hummingbird Mint	pink orange	17	June-Sept	S	M-MD
New!	Agastache ‘Kudos Coral’	Hummingbird Mint	coral pink	16-20	June-Sept	S	M-MD
	Agastache ‘Raspberry Summer’	Hummingbird Mint	raspberry pink	28-32	June-Sept	S	M-MD
	Agastache ‘Sinning’	Sonoran Sunset Hummingbird Mint	lavender-rose	15-20	June-Sept	S	M-MD
New!	Agastache ‘Summer Glow’	Hummingbird Mint	lemon custard	18-20	June-Sept	S	M-MD
	Agastache ‘Violet Visions’	Hummingbird Mint	violet	18	June-Sept	S	M-MD
New!	Alcea rosea ‘Radiant Rose’	Hollyhock	pink shades	60-72	June-Aug	S-ltSh	WM-M
	Alchemilla mollis ‘Auslese’	Lady’s Mantle	yellow/green	18-24	May-June	S-mSh	WM-M
New!	Anemone sylvestris ‘Madonna’	Snowdrop	white	9-12	May-June	S-mSh	WM-M
	Angelica gigas	Angelica	purple	48	July-Aug	S-ltSh	WM-M
	Aquilegia ‘Blue Bird’	Blue Songbird Columbine	blue/white	20-30	April-May	ltSh-mSh	M
	Aquilegia ‘Cardinal’	Cardinal Columbine	red/white	20-28	April-May	ltSh-mSh	WM-M
	Aquilegia ‘Crimson Star’	Red Columbine	red	24	May-June	S-mSh	M
	Aquilegia chrysantha	Yellow Columbine	yellow	18-24	April-May	S-ltSh	M-MD
	Aralia cordata ‘Sun King’	Golden Japanese Spikenard	white shades	30-36	July-Sept	mSh-Sh	WM-M
New!	Aruncus ‘Misty Lace’ PP15798	Goat’s Beard	white shades	24-36	June-July	mSh-Sh	WM-M
	Aster divaricatus ‘Eastern Star’	White Woodland Aster	white	18-24	Aug-Oct	mSh-Sh	WM-MD
New!	Aster KICKIN® ‘Carmine Red’	Fall Aster	magenta red	24-36	Sept-Oct	S-ltSh	WM-MD
	Aster KICKIN® ‘Lavender’	Fall Aster	lavender	24-36	Sept-Oct	S-ltSh	WM-MD
	Aster KICKIN® ‘Lilac Blue’	Fall Aster	blue	24-36	Sept-Oct	S-ltSh	WM-MD
	Aster KICKIN® ‘Pink Chiffon’	Fall Aster	pink	24-26	Sept-Oct	S-ltSh	WM-MD
New!	Astilbe ‘Amber Moon’	Astilbe	pink	34-38	April-May	mSh-Sh	WM-M
	Centranthus ruber ‘Pretty Betsy’	Red Valerian	red	24-36	June-Aug	S	M-MD
	Ceratostigma plumbaginoides	Plumbago	blue	6-8	July-Sept	S-mSh	WM-M
	Convallaria majalis	Lily of the Valley	white	6-8	May-June	ltSh-Sh	WM-M



*Adaptable Perennials - Cont.*

	Coreopsis 'Cosmic Eye'	Tickseed	yellow w/ red eye	12-15	June-Sept	S-ltSh	WM-MD
	Coreopsis 'Full Moon'	Tickseed	yellow	24-30	June-Sept	S-ltSh	WM-MD
New!	Coreopsis 'Imperial Sun'	Tickseed	yellow	18-20	June-Oct	S-ltSh	M
	Coreopsis 'Jethro Tull'	Tickseed	red	15-18	May-Oct	S-ltSh	WM-MD
New!	Coreopsis 'Mayo Clinic Flower of Hope'	Tickseed	yellow	14-20	June-Sept	S-ltSh	WM-MD
	Coreopsis 'Mercury Rising'	Tickseed	yellow/red	30-36	May-Aug	S-ltSh	WM-MD
	Coreopsis 'Star Cluster'	Tickseed	white/purple eye	18-24	June-Sept	S-ltSh	WM-M
	Delesperma cooperi	Ice Plant	rose pink	3-6	June-Aug	S	MD-D
New!	Delesperma 'Fire Wonder'	Wheels of Wonder Ice Plant	red/yellow	4-6	June-Aug	S	MD-D
New!	Delesperma 'Golden Wonder'	Wheels of Wonder Ice Plant	yellow	4-6	June-Aug	S	MD-D
New!	Delesperma 'Hot Pink Wonder'	Wheels of Wonder Ice Plant	bright pink/ylw eye	4-6	June-Aug	S	MD-D
New!	Delesperma 'Orange Wonder'	Wheels of Wonder Ice Plant	orange	4-6	June-Aug	S	MD-D
New!	Delesperma 'Violet Wonder'	Wheels of Wonder Ice Plant	violet	4-6	June-Aug	S	MD-D
	Delosperma 'P001S'	Fire Spinner Hardy Ice Plant	orange/red/pink	1-2	May-Aug	S	MD-D
New!	Dianthus 'Black Cherry Wild'	Pinks	velvety red	6	April-May	S-ltSh	WM-MD
New!	Dianthus 'Coral Reef'	Pinks	pink/shite	9-12	April-May	S-ltSh	WM-MD
	Dianthus 'Firewitch'	Cheddar Pinks	hot pink	7-8	May-June, Sept	S	M-MD
	Dianthus 'Heart Attack'	Pinks	deep red	24	April-May	S-ltSh	WM-MD
	Dianthus 'Pomegranate Kiss'	Pinks	rose pink	6	April-May	S-ltSh	WM-MD
New!	Dicentra 'Alba'	White Bleeding Heart	white	30	April-May	mSh-Sh	WM-M
New!	Dicentra 'Amore Pink'	Amore™ Bleeding Heart	pink	8-14	May-Aug	mSh-Sh	WM-M
New!	Dicentra 'Amore Rose'	Amore™ Bleeding Heart	rose pink	8-14	May-Aug	mSh-Sh	WM-M
	Dicentra 'Gold Heart'	Golden Bleeding Heart	rose pink	18-24	May-June	mSh-Sh	WM-M
	Dicentra 'Valentine'	Bleeding Hearts	rose pink	8-10	May-Sept	mSh-Sh	WM-M
New!	Echinacea 'Cleopatra'	Yellow Coneflower	yellow	16-18	May-Sept	S-ltSh	M-MD
	Echianacea 'Cheyenne Spirit'	Cheyenne Spirit Coneflower	yellow, orange, red	24-28	June-Aug	S-ltSh	M-MD
	'Hot Papaya'	Red Pom-pom Coneflower	red-orange	30-36	June-Aug	S-ltSh	M-MD
	'Julia'	Orange Coneflower	orange	16-18	June-Aug	S-ltSh	M-MD
	'Solar Flare'	Solar Flare Coneflower	magenta red	24-36	June=Aug	S-ltSh	M-MD
	Echinacea 'Pow Wow White'	White Coneflower	white	18-24	June-Aug	S-ltSh	M-MD
	Echinacea Purple Emperor'	Purple Coneflower	pink	15-18	June-Aug	S-ltSh	M-MD
New!	Echium amoenum	Red Feathers	red	10-16	May-June	S	M-MD
	Epimedium grandiflorum 'Lilafée'	Barrenwort	purple	8-12	April-May	ltSh-Sh	WM-MD
New!	Epimedium versicolor 'Sulphureum'	Barrenwort	yellow	10-12	April-May	ltSh-Sh	WM-MD
	Eupatorium dubium 'Little Joe'	Dwarf Joe Pye Weed	pink	36-48	June-Aug	S-ltSh	WM-M
	Euphorbia amygdaloides var.robbaiae	Wood Spurge	yellow	12-18	May-June	ltSh-mSh	WM-MD
New!	Fragaria ananassa 'Gasana'	Everbearing Strawberry	pink	12	May-Sept	S-ltSh	WM-M
New!	'Tristan'	Everbearing Strawberry	magenta	12	May-Sept	S-ltSh	WM-M
	Gallium odoratum	Sweet Woodruff	white	8-12	April-May	mSh-S	WM-M
	Gaura lindheimeri 'Rosyjane'	Butterfly Gaura	red-white	18-24	June-Aug	s-mSh	WM-M
New!	Geranium cantabrigiense 'Biokovo'	Hardy Geranium	white	10-12	May-June	ltSh-mSh	WM-M
New!	Geranium 'Brookside'	Hardy Geranium	blue	18-24	May-Sept	S-mSh	WM-M
	Geranium 'Johnson Blue'	Hardy Geranium	blue	15-18	June-Aug	S-mSh	WM-M
	Geranium sanguineum 'New Hampshire Purple'	Bloody Crane's Bill	purple	12-18	May-June	S-ltSh	WM-MD
	Geranium 'Perfect Storm'	Hardy Geranium	pink/dard centers	12	May-June	S-ltSh	WM-M
	Geranium 'Rozanne'	Hardy geranium	violet/blue	18-20	May-Sept	S-ltSh	WM-M
	Helenium 'Red Jewel'	Helen's Flower	red	30-36	Aug-Sept	S-ltSh	WM-M
	Helenium 'Ruby Tuesday'	Helen's Flower	red	24-36	Aug-Sept	S-ltSh	WM-M
	Helenium 'Salsa'	Helen's Flower	deep red	18-22	Aug-Sept	S-ltSh	WM-M
	Helenium 'Sombrero'	Helen's Flower	yellow	18-22	Aug-Sept	S-ltSh	WM-M
	Helianthus 'Happy Days'	Sunflower	yellow	24	Aug-Sept	S-ltSh	WM-M
	Hemerocallis 'Red Hot Returns'	Happy Ever Appster Daylily	cherry red	24-28	June-Sept	S-ltSh	WM-M
New!	Hemerocallis 'Red Pinnacle'	Daylily	garnet-red w/ ylw	28	July-Aug	S-ltSh	WM-M
New!	Hemerocallis 'Ruby Spider'	Daylily	ruby red	30-36	June-Aug	S-ltSh	WM-M
	Heuchera 'Autumn Leaves'	Coral Bells	red foliage	8-15	May-Nov	ltSh-mSh	M
	'Bella Notte'	Coral Bells	purple red foliage	9-12	May-Nov	ltSh-mSh	M
	'Berry Marmalade'	Coral Bells	purple black lvs	10-18	May-Oct	ltSh-mSh	M
	'Berry Smoothie'	Coral Bells	gold/lime	8-12	May-Oct	S-mSh	M
	'Brazen Raisin'	Dolce® Coral Bells	dark purple foliage	8-12	May-Oct	S-mSh	M
	'Blackberry ice'	CoralBells	purple/silver foliage	10-12	May-Oct	S-mSh	M
	'Delta Dawn'	Coral Bells	cream	8-10	May-June	S-mSh	M
	'Electra'	Coral Bells	golden foliage	8-14	May-Oct	S-mSh	M
	'Electric Lime'	Coral Bells	lime green foliage	12-28	May-Oct	S-mSh	M
New!	'Fire Alarm'	Coral Bells	red foliage	9-12	May-Oct	S-mSh	M
	'Galaxy'	Coral Bells	red w/ pink spots	9-12	May-Oct	S-mSh	M
	'Georgia Peach'	Coral Bells	cream	14	May-June	S-mSh	M
New!	'Grape Expectations'	Coral Bells	grape purple foliage	12	May-Oct	S-mSh	M
	'Lipstick'	Coral Bells	red	12-14	May-June	S-mSh	M
New!	'Lava Lamp'	Coral Bells	purple/orange/red	16	May-Oct	S-mSh	M
	'Magnum'	Coral Bells	huge burgundy leaves	10-12	May-Oct	S-mSh	M
	'Obsidian'	Coral Bells	dark foliage	10	May-Oct	S-mSh	M
	'Southern Comfort'	Coral Bells	tan/peach	12-14	May-Oct	S-mSh	M
New!	Iris 'Coal Seams'	Bearded Iris	coal black	36-40	May-June	S	WM-MD
New!	'Decadence'	Bearded Iris	yellow purple	34-38	May-June	S	WM-MD
	Knautia macedonica 'Mars Midget'	Pincushion Flower	red	24-36	May-Aug	S	M-MD
	Lamium galeobdolon 'Herman's Pride'	Silver Nettle	yellow	6-8	May-June	S-Sh	WM-MD
	Lavandula 'Phenomenal'	Lavender	lavender	24-48	June-Sept	S	M-D
	Lespedeza thunbergii 'Samindare'	Pink Bush Clover	pink	36-48	Aug-Sept	S-ltsh	WM-MD
	Leucanthum vulgare	Ox-eyed Daisy	white	24-36	June-Aug	S-ltSh	M-MD
New!	Monarda 'Bubblegum Blast'	Sugar Buzz™ Bee Balm	hot pink	24	June-Aug	S-ltSh	WM-M
New!	'Cherry Pops'	Sugar Buzz™ Bee Balm	cherry red	20	June-Aug	S-ltSh	WM-M
New!	'Grape Gumball'	Sugar Buzz™ Bee Balm	vibrant magenta	20-24	June-Aug	S-ltSh	WM-M
New!	'Lilac Lollipop'	Sugar Buzz™ Bee Balm	lavender lilac	18-20	June Aug	S-ltSh	WM-M
	Monarda didyma 'Pardon My Pink'	Bee Balm	pink	10-12	June-Aug	S-ltSh	WM-M
	Monarda didyma 'Pardon My Purple'	Bee Balm	purple	10-12	June-Aug	S-ltSh	WM-M
New!	Nepeta x fassenii 'Junior Walker'	Dwarf Catmint	lt. blue	18	May-Sept	S-ltSh	W-MD
	Nepeta x fassenii 'Walker's Low'	Catmint	lt. blue	18-30	May-Sept	S-ltSh	M-MD
	Penstemon 'Dark Towers'	Beardtongue	pink	30	May-June	S-ltSh	M-MD
	Perovskia atriplicifolia	Russian Sage	lavender/blue	48	May-Aug	S	M-MD
New!	'WALPPB'	PEEK-A-BLUE® Russian Sage	lavender	24	June-Sept	S	M-MD

#### Adaptable Perennials - Cont.

	'Little Spire'	Russian Sage	lavender/blue	24	May-Aug	S	M-MD
New!	'Rocketman'	Upright Russian Sage	lavender/blue	24-36	June-Aug	S	M-MD
New!	Rudbeckia fulgida var. sullivantii 'Little Goldstar'	Blackeyed Susan	yellow	12-16	July-Sept	S-ltSh	WM-M
New!	Salvia greggii 'Furman's Red'	Furman's Red Sage	red	18-24	Aug-Sept	S	M-MD
	Salvia greggii 'Ultra Violet'	Ultra Violet Autumn Sage	Violet purple	18-20	Aug-Sept	S	M-MD
	Salvia X nemerosa 'Caradonna'	Caradonna Sage	dark purple	18-30	May-June	S	M-MD
New!	'Crystal Blue'	Blue Salvia	sky blue	18	May-June	S	M-MD
New!	'Pink Dawn'	Pink Garden Sage	pink	16-20	May-June	S	M-MD
New!	'Violet Riot'	Garden Sage	dark purple	22	May-June	S	M-MD
	Scabiosa columbaria 'Butterfly Blue'	Pincushion Flower	lavender/blue	12-18	May-Oct	S-ltSh	M-MD
	Sedum 'Autumn Fire'	Autumn Stonecrop	rosy pink	24-30	Aug-Oct	S	M-MD
	Sedum 'Dazzleberry'	Stonecrop	pink	6-8	Aug-Sept	S	M-D
	Sedum 'Firecracker'	Stonecrop	red foliage	6	Aug-Oct	S	M-D
New!	Sedum 'Lemon Jade'	Stonecrop	yellow	16-18	Aug-Sept	S	M-D
	Sedum 'Lime Zinger'	Stonecrop	rose red	4-6	Aug-Oct	S	M-D
New!	Sedum 'Marina'	Stonecrop	aqua grn lvs	10-12	Aug-Oct	S	M-D
New!	Sedum 'Pure Joy'	Stonecrop	soft pink	10-12	Aug-Oct	S	M-D
	Sedum 'Thunderhead'	Stonecrop	deep rose	24-30	Aug-Oct	S	M-D
New!	Sempervivum 'Rocknoll Rosette'	Hens and Chicks	red green leaves	3-4	May-Oct	S	M-D
	Solidago 'Little Lemon'	Dwarf Goldenrod	yellow	8-10	Sept-Oct	S	M-MD
	Solidago rugosa 'Fireworks'	Fireworks Goldenrod	yellow	36-48	Sept-Oct	S	WM-MD
	Solidago 'Wichita Mountain'	Wand Goldenrod	yellow	24-30	Sept-Oct	S	WM-M
New!	Tanacetum albipannosum	Silver-leaf Tansy	white	18	June-Aug	S	M-MD
	Tanacetum niveum	Snowy Tansy	white	18	May-July	S	M-MD
	Tradescantia 'Amethyst Kiss'	Everblooming Spiderwort	light purple	12-18	May-Sept	S-ltSh	WM-MD
New!	Veronica 'Very Van Gogh'	Speedwell	purple spikes	15-18	June-Sept	S-ltSh	WM-M

#### VARIOUS HOSTAS:

Abiqua Drinking Gourd, Autumn Frost, Big Daddy, Ben Vernooy, Blue Angel, Blue Mammoth, Blue Mouse Ears, Dream Queen, El Nino, Empress Wu, First Frost, Gypsy Rose, Halcyon, High Society, Humpback Whale, Ivory Queen, June, June Fever, June Spirit, Key West, Mighty Mouse, Pocketful of Sunshine, Praying Hands, Pure Heart, Regal Supreme, Ripple Effect, sieboldiana 'Elegans', Tokudama Aureonebulosa, Tokudama Flavocircinalis, Touch of Class.

A great selection of herbs will be available from the Neff Family Farm at the FloraKansas Plant Sale.

## Infrastructure Improvements Planned for 2015

By Scott Vogt, Executive Director

In 2012, the Dyck Arboretum of the Plains board of trustees along with arboretum staff went thorough a strategic planning process to identify strengths, weaknesses, opportunities and threats. That process has helped guide many of our decisions since that time. We also focused our attention on areas within the arboretum that needed to be addressed in the next three years, including a new concrete pathway and interpretative signage.

Over the past two years, the arboretum has replaced nearly half of the 20-year old main asphalt path with concrete. The arboretum has received many positive comments about the new path. We will continue overhauling the path with funding support from Excel Industries, Inc., The Ash Grove Charitable Foundation, and gifts from many arboretum supporters.

With much of the new path installed, our focus is turning toward improving the visitor experience in multiple ways including better interpretive signage. In December, the arboretum received a grant from the Stanley Smith Horticultural Trust to fund new signs. These signs will be in close proximity to displays along the main and auxiliary paths. Currently, many of these displays do not have any interpretive signage.

New signs will be coupled with plant identification labels and linked to the arboretum website through quick response (QR) codes. One of our goals with new signage is to provoke thought and inspire visitors to become engaged in horticulture through native landscaping. This inspiration could come in the interpretation of a beautiful display or ecosystem. We believe that visitors who absorb what they experience at the arboretum will become engaged in our mission and work to improve their own home landscapes.

Look for these improvements in 2015. We are excited about the new path and pending new signage. This prairie garden is here to serve you. If you have questions or comments about anything happening at the arboretum, please let us know.



Dated signage in the arboretum will be getting an upgrade in 2015

Give to the path renovation project at [dyckarboretum.org/giving-opportunities/](http://dyckarboretum.org/giving-opportunities/)



# Support Dyck Arboretum Through Dillons Community Rewards

By Janelle Flory Schrock, Office Manager

Beginning February 1st, Dillons and other Kroger affiliates launched the Dillons Community Rewards program to help shoppers support a non-profit or charitable organization through their grocery purchases. The arboretum is happy to be one of the participating organizations and we'd like to invite you to participate!

For anyone who shops at Dillons and uses a Dillons Plus card to get fuel points, etc, after you enroll in this program, every time you scan your Plus card at the register, Dillons will give 5% of your purchase to the organization of your choice!

We know you may have other organizations you would like to support. Please be aware that you are limited to supporting one organization at a time. However, you can change the organization any time by logging into the Dillons Community Rewards site and changing your preferences. We are very grateful to Dillons for this opportunity for our members and supporters to guide their potential giving dollars to the arboretum and other worthy causes. Thank you for supporting us in this easy way!



## TO CREATE AN ONLINE ACCOUNT AT THE DILLONS WEBSITE:

1. Visit [www.dillons.com/communityrewards](http://www.dillons.com/communityrewards) (substitute Dillons, Bakers or Gerbes for banner depending on your location).
2. Click on "Register" at the top of the page.
3. Enter your email address, password, zip code (select preferred store) and check the box if you desire to receive email communication from us.
4. Click on "Creat Account" at the bottom of the page.
5. You will receive an email confirmation to your inbox. To activate your account click on the link in the body of the email and enter your sign-in information to confirm.

## TO ENROLL IN THE COMMUNITY REWARDS PROGRAM:

1. Sign in at [www.dillons.com/communityrewards](http://www.dillons.com/communityrewards) (substitute Dillons, Bakers or Gerbes for banner depending on your location).
2. Click on "Enroll Now."
3. Enter the 5-digit NPO (Dyck Arboretum is 10114) and search.
4. Select "Dyck Arboretum" and click on "Enroll."

## Renew or Upgrade Your Membership in 2015

Like a common milkweed sprout with monarch eggs ready to hatch, the arboretum is growing, ever-changing, and full of exciting potential. Thank you for supporting our mission by making a special contribution or by upgrading your membership today.

### Dyck Arboretum of the Plains Membership

Name \_\_\_\_\_  
Address \_\_\_\_\_  
City/State/Zip \_\_\_\_\_  
Phone \_\_\_\_\_  
Email \_\_\_\_\_

Membership Levels			
Senior Citizen	\$25	Steward of the Earth	\$100
Individual	\$30	Pioneer	\$250
Family	\$40	Plainskeeper	\$500

When you become a member, you become part of the arboretum...not just what it is today, but also what it is destined to become.

As a member you receive:

- Free admission to the garden and to more than 250 gardens and arboreta in the United States and Canada
- 10% discount on arboretum plants at FloraKansas, the spring and fall plant sales
- Advance notice of classes, lectures, tours and workshops
- A one-year free subscription to Better Homes & Gardens magazine (optional)
- Discounted admission at arboretum events and our gift shop

Join online at [dyckarboretum.org/become-a-member/](http://dyckarboretum.org/become-a-member/)



# Dyck Arboretum of the Plains

Hesston College  
P.O. Box 3000  
Hesston, KS 67062  
620-327-8127  
[www.dyckarboretum.org](http://www.dyckarboretum.org)  
[arboretum@hesston.edu](mailto:arboretum@hesston.edu)



Address Service Requested

---

Non-Profit Org.  
U.S. Postage  
**PAID**  
Hesston, KS  
Permit No. 5

---

## Summer Soirée - Celebrating Prairie Sunday, June 28, 2015 from 6:30 to 9:00 p.m.

We invite you to join us for our Summer Soirée on Sunday, June 28. The evening will feature gourmet food, a fantastic silent auction, and a prairie-centered program. This year we are happy to host Michael Haddock, co-author of the new edition of *Kansas Wildflowers and Weeds*, as well as the Tallgrass Express String Band.

Tickets are \$80 per individual, \$150 for a couple, or \$550 for a table of eight. Reserve your seats today for this elegant and educational evening on the prairie!

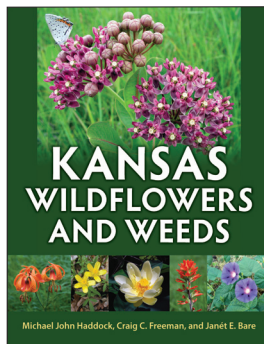

### Staff

Scott Vogt, Executive Director/  
Horticulturist  
Brad Guhr, Education/Prairie Restoration/  
Concert Series Coordinator  
Janelle Flory Schrock, Office Manager  
Brett Prothro, Grounds Manager

### Board of Trustees

Christine Downey-Schmidt - Inman,  
(Chair)  
LeAnn Clark - Hesston  
Connor Dyck - Wichita  
Katy Goering - Newton  
Lorna Habegger Harder - Hesston  
Mark Landes - Hesston  
DeDee Lehman - Hesston  
Forrest Miller - Newton  
Gaylen Neufeld - Hesston  
Jonathan D. (J.D.) Spicher -  
Weatherby Lake, MO